

CULTURE

LAB

L I C

DREAMSCAPES
by Carol Crawford

Gallery and Theater floor plans

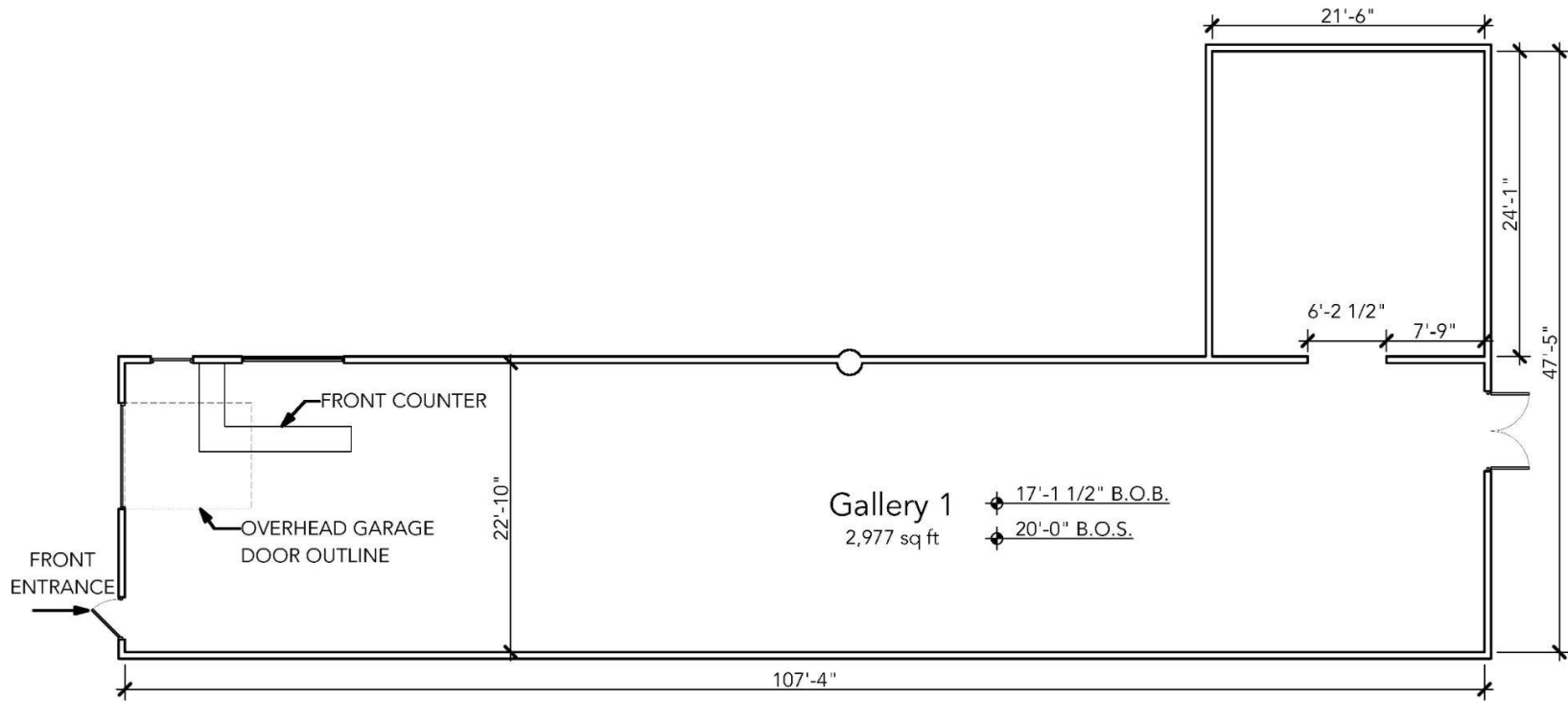

Gallery 1 Information



Spatial Details

Square Footages |
 Gallery 1: 2,977 SQ. FT.
 Ceiling Heights |
 B.O.S. = Bottom of Slab
 B.O.B. = Bottom of Beam

Contact

info@culturelablic.org

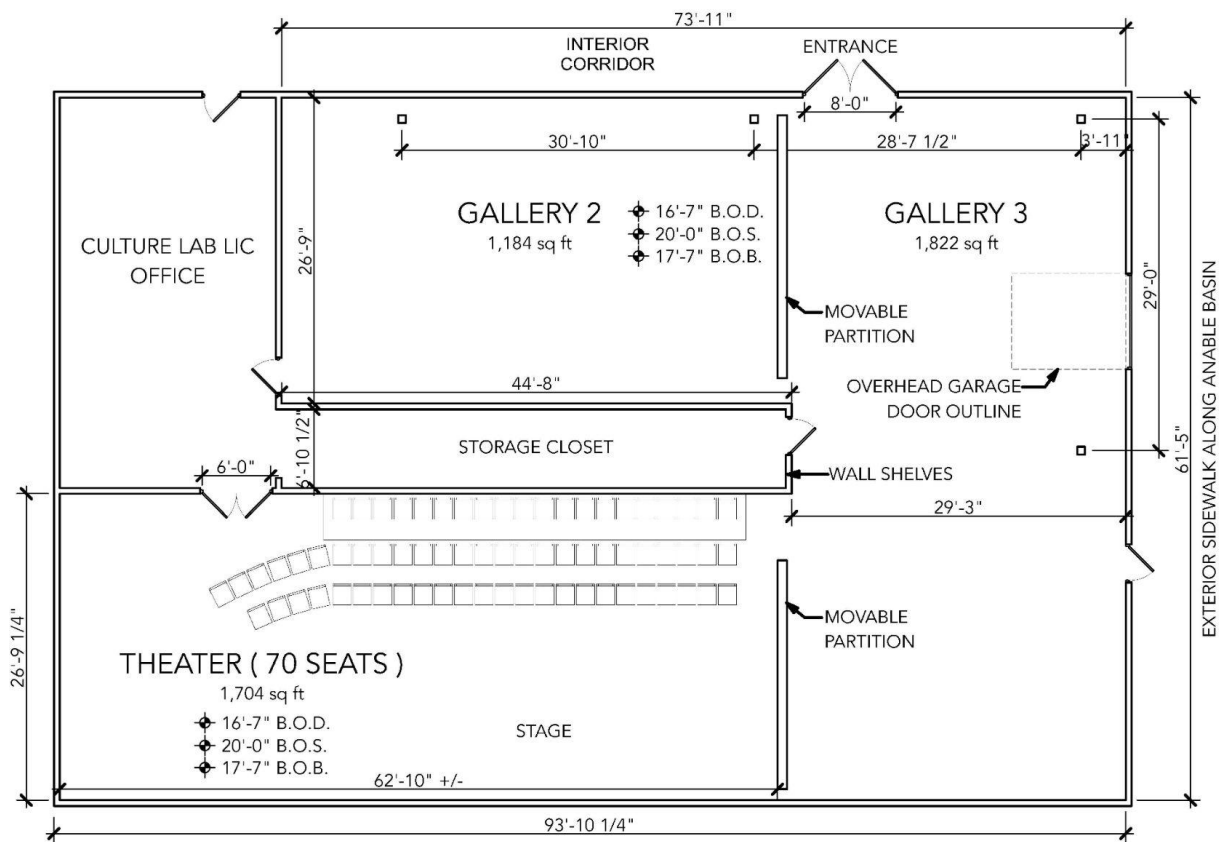

Gallery 2, 3, & Theater Information



Spatial Details

Square Footages |
 Gallery 2: 1,184 SQ. FT.
 Gallery 3: 1,822 SQ. FT.
 Theater: 1,704 SQ. FT.
 Ceiling Heights |
 B.O.S. = Bottom of Slab
 B.O.B. = Bottom of Beam
 B.O.D. = Bottom of Deck

Contact

info@culturelablic.org